

## DELUGE VALVE MODEL FIG12



### PRODUCTION STANDARDS

**MODEL FIG12 | DN50 - DN200  
PN10 - PN16**

**Connection** EN1092-2 ISO 7005-2

**Face to Face** Flange x Flange

**Pressure Class** PN 16

### DESCRIPTION

- The AUT Model FIG 12 Deluge Valve DN50 thru DN200 (2" thru 8" inch) is a diaphragm type valve designed for vertical installation and for fire protection system service.
- They are used as "automatic water control valves" in deluge systems. When properly trimmed, the FIG 12 deluge valves are also able to provide actuation of fire alarms upon system operation.
- The diaphragm style design of the FIG 12 Deluge valve allows external resetting which provides for easy resetting of a deluge system without having to open a valve cover to manually reposition a clapper and / or latch mechanism.
- Simply repressurizing the diaphragm chamber resets the valve

### MATERIAL SELECTION

No	Items	Material
1	Valve Body	Ductile iron
2	Valve Cover	Ductile Iron
3	Diaphragm	Nylon Fabric, Reinforced, Natural Rubber
4	Spring	Stainless Steel
5	Spring Seat	Nylon
6	Hex Bolt	Stainless Steel
7	Flat Washer	Stainless Steel

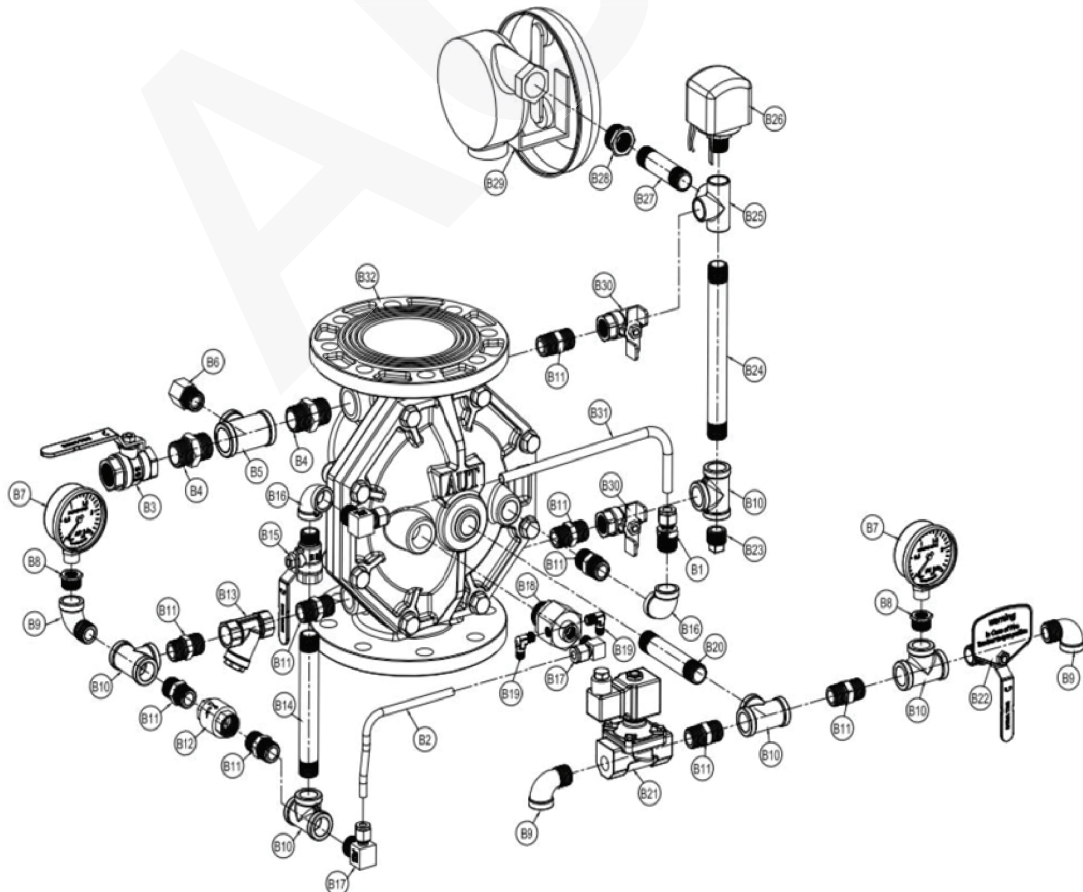

## DELUGE VALVE MODEL FIG12

### VERTICAL ELECTRIC ACTUATION TRIM

No	Description	Materials	Qty
B1	Loose socket hexagon nut \$ 10 union G1/2	304 Stainless Steel	1
B2	Stainless Steel Pipe Ø8	304 Stainless Steel	1
B3	Ball Valve G3/4	Copper Alloy Combination parts	1
B4	Nipple G3/4	304 Stainless Steel	2
B5	Reducer tee with internal thread	304 Stainless Steel	1
B6	Automatic Drain Valve G1/2	304 Stainless Steel Combination parts	1
B7	Pressure Gauge M14*1.5 2.5Mpa	304 Stainless Steel Combination parts	2
B8	Bushing M14*1.5 G 1/2	304 Stainless Steel	2
B9	90° Elbow with internal and external thread G1/2	304 Stainless Steel	3
B10	Tee with internal thread G1/2	304 Stainless Steel	5
B11	Nipple Straight Union G1/2	304 Stainless Steel	9
B12	Check Valve G1/2	Copper Alloy Combination parts	1
B13	Y- Strainer	304 Stainless Steel Combination parts	1
B14	Straight Pipe with external thread G 1/2	304 Stainless Steel	1
B15	Reset Ball Valve G1/2	304 Stainless Steel Combination parts	1
B16	90° Elbow with internal thread G1/2	304 Stainless Steel.	2
B17	90° Angle Fitting G1/2*8	304 Stainless Steel	2
B18	Anti-Reset Valve G3/4*G3/4*G 1/2	Copper Alloy Combination parts	1
B19	90° Angle Fitting G1/8	304 Stainless Steel	2
B20	Straight Pipe with external thread G1/2	304 Stainless Steel	1
B21	Solenoid Valve G1/2	Copper Alloy Combination parts	1
B22	Ball Valve G1/2	Copper Alloy Combination parts	1
B23	Plug G1/2	304 Stainless Steel	1
B24	Straight Pipe with external thread G 1/2	304 Stainless Steel	1
B25	3D Four Way with external thread G1/2	304 Stainless Steel	1
B26	Pressure Switch G1/2	Copper Alloy Combination parts	1
B27	Straight Pipe with external thread G1/2	304 Stainless Steel	1
B28	Bushing G 1/2*C3/4	304 Stainless Steel	1
B29	Water Motor Alarm G3/4	Aluminum Alloy Combination parts	1
B30	Ball Valve with short handle	304 Stainless Steel	2
B31	Stainless Steel Pipe 10	304 Stainless Steel	1
B32	Valve Body	GGG50-10 Combination parts	1

# DELUGE VALVE MODEL FIG12

## DELUGE VALVE

The FIG 12 Deluge valves are for vertical installation only, and are rated for use at a maximum service pressure of 16 Bar (232 PSI)  
End connections are flange x flange, drilled per either EN...GB or ISO specifications shown in Figure 2. Valve trim port connections are available as ISO 7-1 threaded only. Components for the DN50 thru DN300 (2" thru 12" inch), Model FIG 12 Deluge Valves are shown in Figure 1.

### Notice

- The model FIG 12 Deluge Valve with Electric Actuation Trim described here in must be installed and maintained in compliance with these documents, as well as with the applicable standards of the National Fire Protection Association, in addition to the standards of any other authorities having jurisdiction. Failure to do so may impair the performance of these devices.

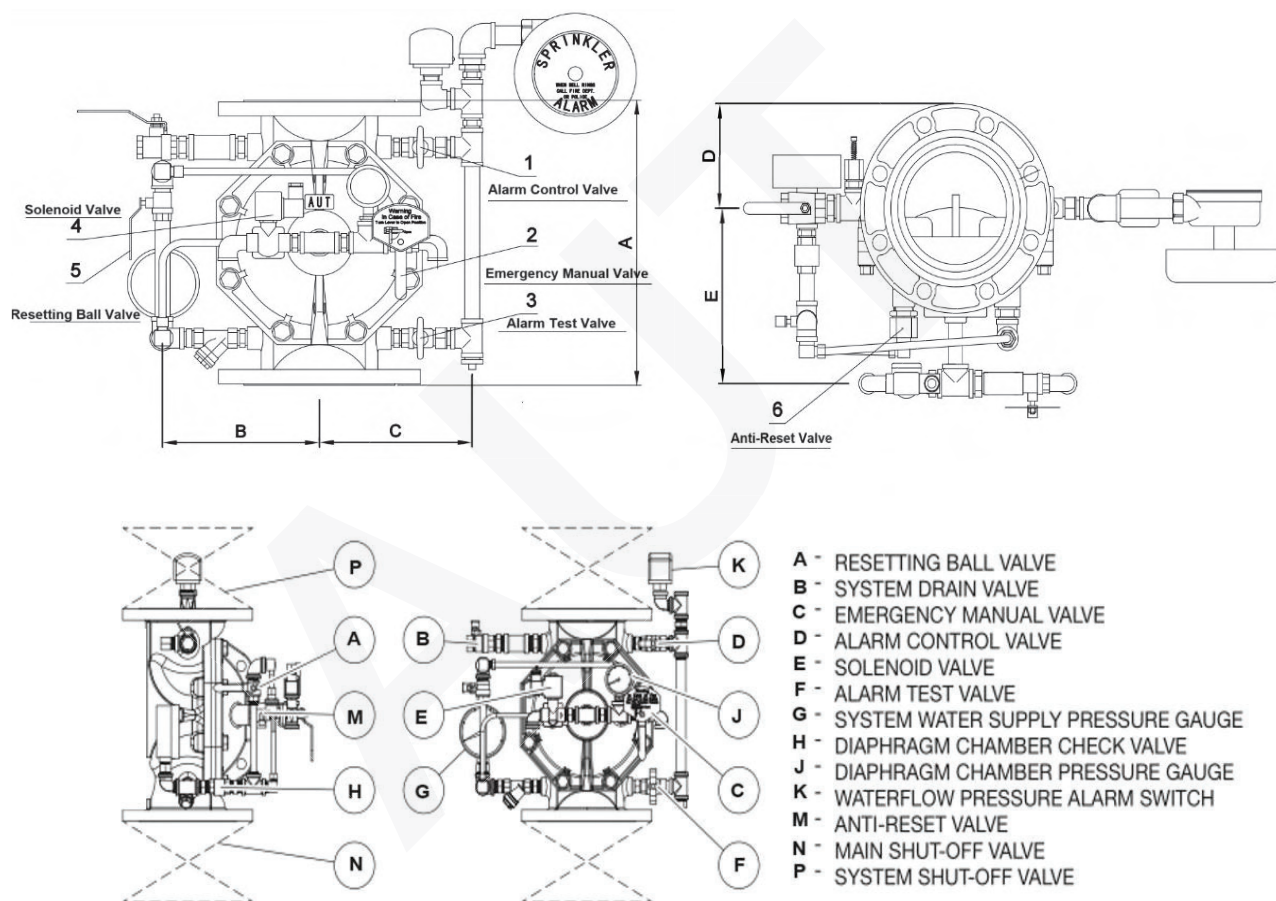

Size	Nominal Dimension in Millimeter				
	A	B	C	D	E
50	326	200	98	300	210
65	326	200	98	300	210
80	330	200	108	300	210
100	330	200	108	300	210
125	400	215	125	330	210
150	400	220	140	330	210
200	508	270	168	350	240